

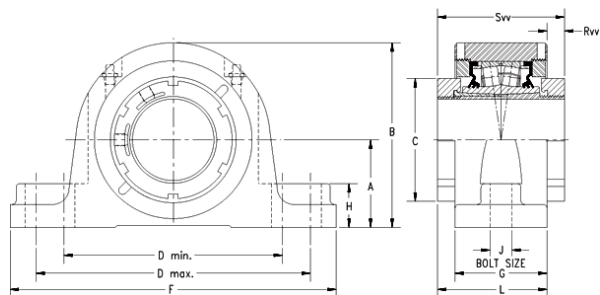

**TIMKEN QVVPL16V211S Solid Block -
Spherical Roller Bearing Housed Units**

Bearing No. QVVPL16V211S



QVVPL16V211S Bearing 2D drawings and 3D CAD models

Engineering Group	Mounted Bearing
Shaft Size	2-11/16 in
Shaft Size Type	Imperial
Full Timken Part Number	QVVPL16V211SB
Locking Style	Double V-Lock
Weight	28 lb
Housing Style	Two-Bolt Pillow Block
UPC Code	0883450172271
Dimension A	3.25 in
Dimension B	6.59 in
Dimension C	4.19 in
Dimension D Max	8.40 in
Dimension D Min	7.70 in
Dimension F	10.44 in
Dimension G	3.0000 in
Dimension H	1.38 in
Dimension J (Bolt Size)	0.750 in
Dimension L	3.59 in
Dimension RVV	0.59 in
Dimension SVV	4.18 in
C - Dynamic Load (Basic)	57200 lb
C0 - Static Load	62500 lb
e - Geometry Factor	0.22
Y1 - Geometry Factor	3.14
Y2 - Geometry Factor	4.67



LOXM SUR S.R.L.

Oil Lubrication - M/N Seal	1500 rpm
Oil Lubrication - T Seal	2650 rpm
Oil Lubrication - B/C/O Seal	1200 rpm
Grease Lubrication - M/N Seal	1500 rpm
Grease Lubrication - T Seal	2200 rpm
Grease Lubrication - B/C/O Seal	1150 rpm
Float	0.083 in
Shaft Tolerance	0.0020 in
Eng Internal Radial Clearance - Min	0.0037
Eng Internal Radial Clearance - Max	0.0047
Pre Install Clearance Min	0.0037 in
Pre Install Clearance Max	0.0047 in